

Instalarea - INTEL

Installation - INTEL

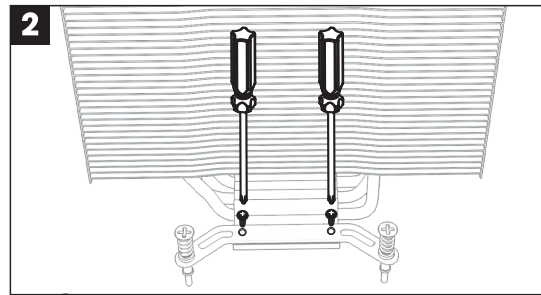
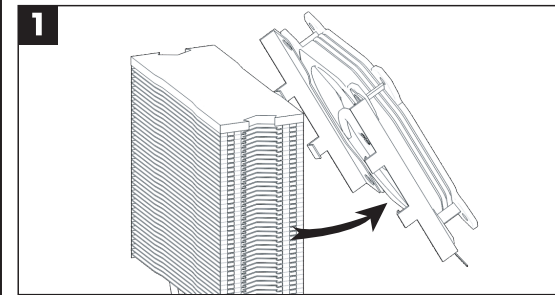

RO Atasati clemele Intel (D) la baza radiatorului folosind suruburile (G) si respectand pozitionarea din imaginea (2).

EN Attach the Intel fasteners (D) to the radiator base using the screws (G) following the positioning in the image (2).

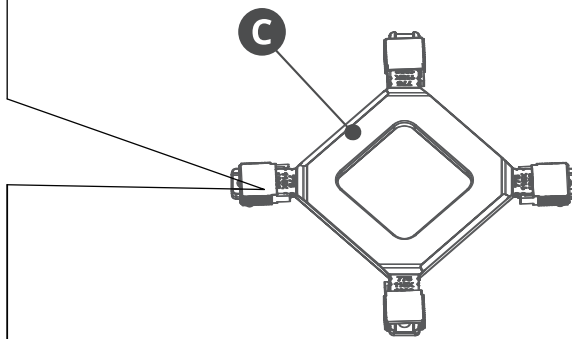
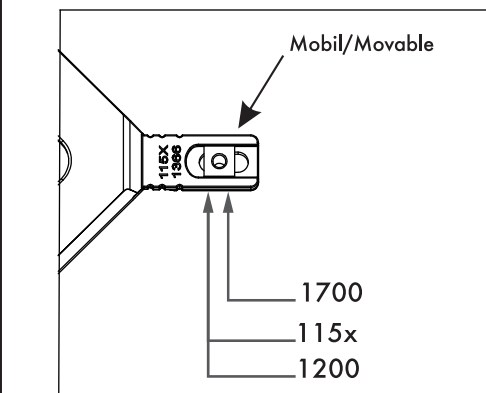
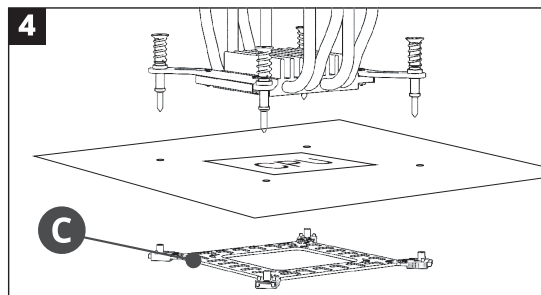
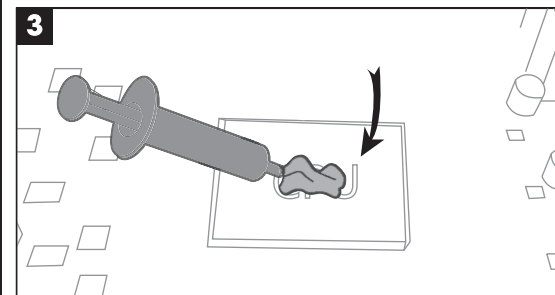

Instalarea - INTEL

Installation - INTEL

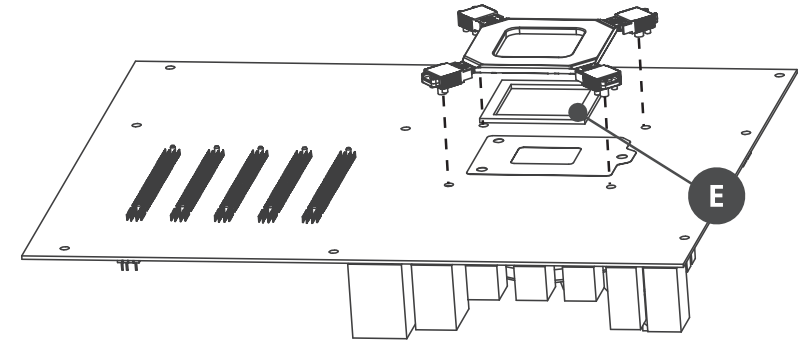

RO Instalati backplate-ul in spatele placii de baza intercaland banda dublu-adeziva (E) si verificand pozitionarea in raport cu gaurile placii de baza.

EN Install the backplate behind the motherboard by inserting the double-sided tape (E) and checking the positioning relative to the motherboard holes.

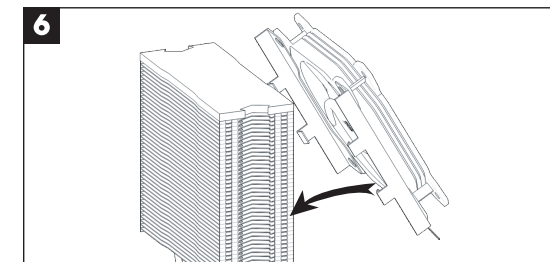
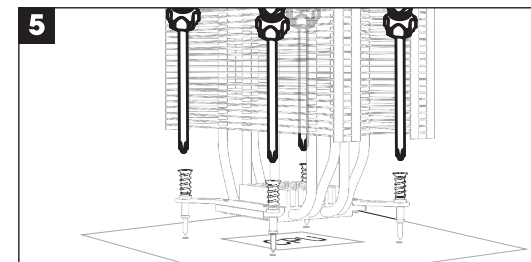

RO Instalati radiatorul si il fixati de backplate folosind suruburile pentru socket 115x/1200. Strangeti pe rand si gradual suruburile opuse (in diagonala) fara a utiliza forta excesiva la final.

EN Install the radiator and secure it to the backplate using the 115x/1200 socket screws. Tighten the opposite screws (diagonally) one at a time and gradually without using excessive force at the end.

RO Conectati cablul 4-pini PWM al ventilatorului la conectorul CPU_FAN de pe placa de baza.

EN Connect the 4-pin PWM cable of the fan to the CPU_FAN connector on the motherboard.